

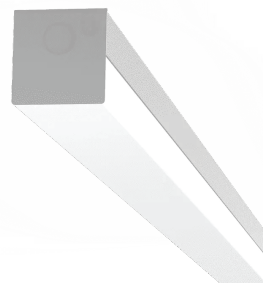

ACCENDO
LIGHTING



General Description:

The Accendo Lighting slip strip is a specification-grade LED strip ideal for offices, conference rooms, retail, and hospitality applications.

The Slim Profile Strip offers a sleek, aesthetically-pleasing appearance without compromising illumination. It has a small profile body, only 2.6" high, and has no visible hardware or mounting holes. Available in 2, 4 or 8-foot models, this new luminaire has a variety of lumen packages ranging from 1500L (19W) to 14,000L (106W) and offers a precision-edged acrylic round or square lens. To keep a consistent look with existing architecture, it's available in matte white, matte black, or silver finishes. Additionally, a symmetric, triple wave or brushed metal diffusing lens insert can provide an even more elegant look. Like many of our products, the strip is "controls ready" to work with virtually any network controls or building automation.



FEATURES

- Lumen packages ranging from 2000L to 6500L.
- An energy-efficient LED luminaire that can be mounted individually or in a continuous row.
- Offers high performance lighting in a cost-efficient strip.
- Small profile body with no visible hardware or mounting holes.
- Power and CCT selectable.

CONSTRUCTION

- Code gauge steel, pre-painted gloss white.
- Optional factory power coat providing a durable and premium finish.
- Symmetric diffuser is available with the round and square lens, providing smooth and even lighting.

ELECTRICAL

- Voltage: 120-277V AC input
- Driver: Class 2, constant current, calibrated to lumen package (0-10V dimming standard)
- Operating temp: -40°C to +40°C (-40°F to +104°F).

CONTROLS

- On/Off occupancy sensor and programmable smart sensor with daylight harvesting available.

MOUNTING

- Surface and adjustable cable mount ready.
- Optional cable canopy and pendant mount accessories available.

WARRANTY

- Backed by Accendo's limited 5-year warranty.

Ordering Information

Ordering Example: ALSSLED-4P1-CS-DIM-RD-C5-EM-XLS

	MODEL	CCT	Driver	Lens/Optics	Mounting	Options	Series
ALSSLED	2P1	LOW 2000L	CS¹ 3500K 4000K 5000K	RD Round SQ Square NO None	C5 Cable Canopy C10 Cable Canopy PND¹ Pendant Canopy	EM² Emergency Battery Back-up SRG 20kA Surge Protector ME Molded End Caps	XLS
	2FT	MED 3000L HIGH 3500L					
	4P1	LOW 3000L					
	4FT	MED 4000L HIGH 5000L				OS Occupancy Sensor S2 Smart Sensor, 8'H/48'D S3 Smart Sensor, 20'H/40'D	
	4P2	LOW 4000L				MW Powder Coat Matte White FB Powder Coat Matte Black SV Powder Coat Silver CP Custom Powder Coat Color	
	4FT	MED 5000L HIGH 6500L				WG Wire Guard 10Y 10 Year Warranty	

1. CCT Selective (CS) options includes dip switch for 3500K, 4000K, and 5000K.
2. EM not available with 2 ft size option.
3. Must be paired with Canopy-B accessory.

Additional:

PHOTOMETRIC DATA

MODEL	PACKAGE	POWER	3500K			4000K			5000K		
			LUMENS	WATTS	EFFICACY	LUMENS	WATTS	EFFICACY	LUMENS	WATTS	EFFICACY
SPS2	P1	LOW	2311	17	134	2461	17	142	2391	17	138
		MED	3046	24	126	3309	24	137	3159	24	131
		HIGH	3726	32	118	4142	32	131	3865	32	122
SPS4	P1	LOW	3012	20	152	3138	20	158	3087	20	156
		MED	4052	28	147	4266	28	155	4152	28	151
		HIGH	5059	36	142	5370	36	150	5209	36	146
	P2	LOW	4291	30	144	4535	30	153	4268	30	144
		MED	5320	38	139	5692	38	149	5358	38	140
		HIGH	6680	51	130	7286	51	142	6858	51	134

STANDARD SIZES

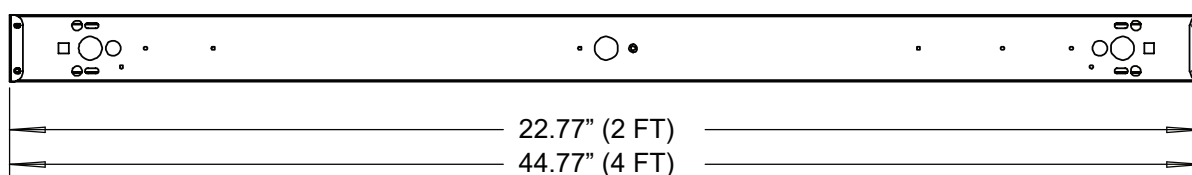
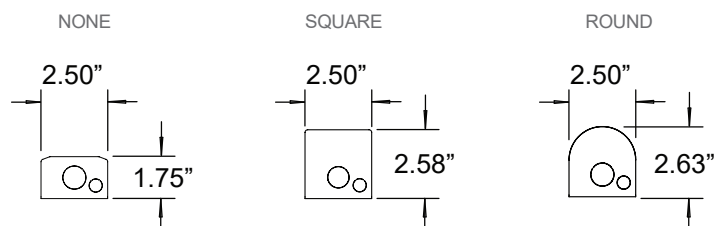

ACCESSORIES

PENDANT-A

LENGTH	FINISH
18 18\"	MW Matte White
24 24\"	CM Color Match
36 36\"	

DESCRIPTION

- Stationary pendant & canopy set
- Thread 1/4\"
- Requires two per single fixture
- Must select PND in the order logic options
- For continuous row consult factory



PENDANT-B

LENGTH	FINISH
18 18\"	MW Matte White
24 24\"	CM Color Match
36 36\"	

DESCRIPTION

- Swivel pendant & canopy set
- Thread 1/4\"
- Requires two per single fixture
- Must select PND in the order logic options
- For continuous row consult factory



MS0043

S-Hook

MS0351

3 ft Chain

DESCRIPTION

- S-hook & chain mounting option
- Custom length chain available (consult factory)

